

**T, DT
ST
DST**

Pinion Shafts

Materials

20° P.A.

STD : Steel 214M15/045M10 and
Stainless Steel 303S21/3 (En58)

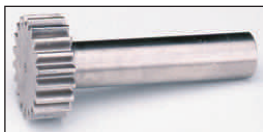

T & ST Single

Single sided

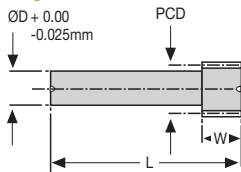

DT & DST Double

Double sided

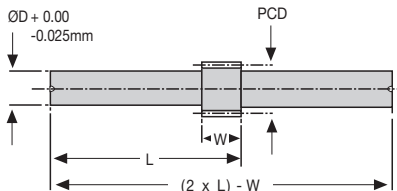

*Other numbers of teeth available,
please see gear section.*

DISCOUNTS

1 - 5	List Price
6 - 19	- 12%
20 - 39	- 25%
40 - 59	- 33%
60 - 99	- 37%
100 - 200	- 42%

Pinions & Shafts MOD 0.25-0.5

PART NUMBER		PITCH MOD	TEETH	PCD	L (mm)	W (mm)	ØD (mm)	PRICE EACH 1 - 5			
STD.EN32	STAINLESS							STD.T	DT	ST	DST
T0.25-15	ST0.25-15	0.25	15	3.75	20	2.50	3	£14.77	£22.26	£22.12	£33.24
T0.25-18	ST0.25-18	0.25	18	4.50	20	2.50	3	£16.04	£24.10	£22.78	£34.23
T0.3-16	ST0.3-16	0.30	16	4.80	20	2.50	3	£14.97	£22.47	£22.57	£33.56
T0.3-20	ST0.3-20	0.30	20	6.00	20	2.50	3	£16.15	£24.46	£22.94	£34.39
T0.4-18	ST0.4-18	0.40	18	7.20	25	3.00	5	£15.23	£22.93	£22.85	£34.35
T0.4-27	ST0.4-27	0.40	27	10.80	25	3.00	5	£16.45	£24.72	£23.15	£34.76
T0.5-16	ST0.5-16	0.50	16	8.00	25	3.00	6	£15.97	£24.03	£24.10	£36.19
T0.5-20	ST0.5-20	0.50	20	10.00	25	3.00	6	£16.25	£24.51	£24.70	£37.08
T0.5-24	ST0.5-24	0.50	24	12.00	25	3.00	6	£17.13	£25.74	£25.67	£38.56



20° P.A.

STD : Steel 214M15/045M10 and
Stainless Steel 303S21/3 (En58)



T & ST Single

Single sided

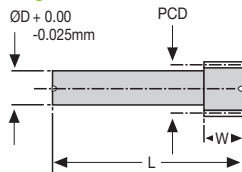

DT & DST Double

Double sided

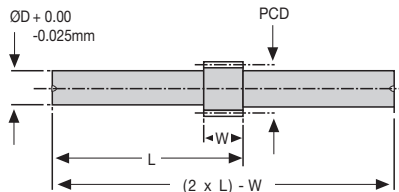

*Other numbers of teeth available,
please see gear section.*

DISCOUNTS

1 - 5	List Price
6 - 19	- 12%
20 - 39	- 25%
40 - 59	- 33%
60 - 99	- 37%
100 - 200	- 42%

PART NUMBER		PITCH DP	TEETH	PCD	L (ins)	W (ins)	ØD (ins)	PRICE EACH 1 - 5			
STD.EN32	STAINLESS							STD	EN32	DT	ST
T96-15	ST96-15	96	15	0.156	0.750	0.093	0.1250	£14.77	£22.26	£22.12	£33.24
T96-18	ST96-18	96	18	0.187	0.750	0.093	0.1250	£16.04	£24.10	£22.78	£34.23
T80-16	ST80-16	80	16	0.200	0.750	0.093	0.1250	£15.00	£22.48	£22.71	£34.04
T80-20	ST80-20	80	20	0.250	0.750	0.093	0.1250	£16.25	£24.61	£23.50	£35.30
T72-18	ST72-18	72	18	0.250	1.000	0.125	0.1875	£15.23	£22.93	£23.25	£34.95
T72-27	ST72-27	72	27	0.375	1.000	0.125	0.1875	£16.72	£25.12	£24.21	£36.36
T64-16	ST64-16	64	16	0.2500	1.000	0.125	0.1875	£15.23	£22.93	£22.85	£34.35
T64-20	ST64-20	64	20	0.3125	1.000	0.125	0.1875	£16.13	£24.21	£23.83	£35.82
T64-24	ST64-24	64	24	0.3750	1.000	0.125	0.1875	£16.72	£25.12	£25.08	£37.71

PART NUMBER		PITCH					PRICE EACH 1 - 5					
STD.EN32	STAINLESS	DP	TEETH	PCD	L (ins)	W (ins)	ØD (ins)	STD.EN32 T	STAINLESS DT	ST ST	DST	
T48-15	ST48-15	48	15	0.3125	1.250	0.187	0.2500	£15.97	£24.03	£24.10	£36.19	
T48-16	ST48-16	48	16	0.3330	1.250	0.187	0.2500	£16.25	£24.51	£24.70	£37.08	
T48-18	ST48-18	48	18	0.3750	1.250	0.187	0.2500	£17.13	£25.74	£25.67	£38.56	
T32-14	ST32-14	32	14	0.4735	1.500	0.187	0.3125	£17.87	£26.82	£26.80	£40.25	
T32-16	ST32-16	32	16	0.5000	1.500	0.187	0.3125	£18.49	£27.86	£27.60	£41.45	
T32-20	ST32-20	32	20	0.6250	1.500	0.187	0.3125	£19.07	£28.67	£28.66	£43.03	
T24-12	ST24-12	24	12	0.5000	2.000	0.312	0.3750	£21.61	£32.43	£32.45	£48.79	
T24-15	ST24-15	24	15	0.6250	2.000	0.312	0.3750	£22.30	£33.50	£33.17	£49.82	
T24-18	ST24-18	24	18	0.7500	2.000	0.312	0.3750	£23.09	£34.72	£34.60	£51.95	
T20-13	ST20-13	20	13	0.6500	3.000	0.375	0.5000	£22.38	£33.61	£44.02	£66.12	
T20-16	ST20-16	20	16	0.8000	3.000	0.375	0.5000	£22.78	£34.24	£44.62	£67.13	
T20-20	ST20-20	20	20	1.0000	3.000	0.375	0.5000	£23.25	£34.95	£45.35	£68.05	
T16-13	ST16-13	16	13	0.8125	3.000	0.500	0.6250	£22.69	£34.03	£51.40	£77.13	
T16-16	ST16-16	16	16	1.0000	3.000	0.500	0.6250	£23.26	£34.98	£52.55	£78.92	
T16-18	ST16-18	16	18	1.1250	3.000	0.500	0.6250	£23.99	£36.04	£53.46	£80.23	
T12-12	ST12-12	12	12	1.0000	4.000	0.750	0.7500	£24.81	£37.31	£54.70	£82.08	
T12-15	ST12-15	12	15	1.2500	4.000	0.750	0.7500	£27.31	£40.93	£58.38	£87.67	
T12-18	ST12-18	12	18	1.5000	4.000	0.750	0.7500	£30.32	£45.47	£62.84	£94.35	
T10-12	ST10-12	10	12	1.2000	4.000	1.000	0.7500	£30.77	£46.21	£61.60	£92.53	
T10-14	ST10-14	10	14	1.4000	4.000	1.000	0.7500	£32.63	£48.98	£65.37	£98.10	
T10-16	ST10-16	10	16	1.6000	4.000	1.000	0.7500	£34.47	£51.71	£69.01	£103.59	
T8-12	ST8-12	8	12	1.5000	4.250	1.250	0.8750	£43.13	£64.76	£71.19	£106.91	
T8-14	ST8-14	8	14	1.7000	4.250	1.250	0.8750	£44.40	£66.72	£73.37	£110.14	
T8-16	ST8-16	8	16	2.0000	4.250	1.250	0.8750	£48.53	£72.86	£80.16	£120.27	
T6-12	ST6-12	6	12	2.0000	4.500	1.500	1.2500	£54.90	£82.37	£90.62	£135.98	
T6-15	ST6-15	6	15	2.5000	4.500	1.500	1.2500	£57.23	£85.86	£94.46	£141.78	
T6-18	ST6-18	6	18	3.0000	4.500	1.500	1.2500	£60.14	£90.34	£99.34	£148.67	

'Never Knowingly Outpriced'