

Couplings

Material

Single Beam

Stainless Steel

Couplings
Single Beam



Materials & Finishes

Couplings: *Stainless Steel 303 S31*

Fasteners: *Stainless Steel*

General description

More flexible than Multi-Beam but less torsional rigidity.

Where to use

Stepper drives, encoders, general purpose light duty power transmission applications.

Speeds

Up to 5000 rpm in standard form.

Peak torque largest size

30 Nm

Standard bores

3mm to 26mm

Temperature range

-40 °C to +140 °C

Electrically isolating

Aluminium

Stainless Steel

No

Connection

Clamp or Set Screw

3.50



Unit 14, Foxwood Industrial Park, Foxwood Rd. Chesterfield, Derbyshire S41 9RN

Telephone +44(0)1246 268080 Fax +44(0)1246 260003

Material

Stainless Steel

Couplings

Single Beam

Set screw hubs

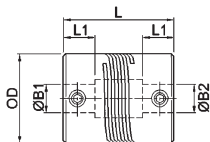

Clamp hubs

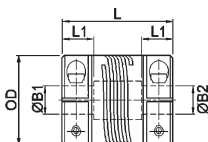

Performance

Coupling Size	Peak Torque (Nm)	Max misalignment compensation			Nominal stiffness at std. bore size	
		Angular deg	Radial mm	Axial mm	Bore	Torsional (Nm/rad)
16	1.2	5	0.25	0.25	5	16
19	2.3	5	0.25	0.25	6	33
25	4.3	5	0.25	0.25	10	45
32	7.8	5	0.25	0.25	12	84
38	20	5	0.25	0.25	16	195
50	30	5	0.25	0.25	20	320

Couplings

Material

Single Beam

Stainless Steel

Dimensions & Order Codes

Couplings Single Beam

PART NUMBER		Coupling	Dimensions					
Set Screw Style	Clamp Style		Size	ØD	L	L1	Min B1	Min B2
HPC820.16.----	-	16	15.9	20	6.0	3	4	6.35
-	HPC821.16.----			22	6.5			
HPC820.19.----	-	19	19.1	20	6.0	4	4.76	8
-	HPC821.19.----			28	8.0			
HPC820.25.----	-	25	25.4	24	7.5	5	6	10
-	HPC821.25.----			30	10.0			
HPC820.32.----	-	32	31.8	30	10.0	6	8	16
-	HPC821.32.----			38	12.0			
HPC820.38.----	-	38	38.1	50	16.0	8	12	19
-	HPC821.38.----			50	16.0			
HPC820.50.----	-	50	50.8	54	18.0	10	16	26
-	HPC821.50.----			54	18.0			

Order codes: Please combine the coupling part number in the above table with the bore reference in the standard bores table (see below).

Please identify both bores to complete the part number eg. HPC820.16. 14 24

Part Number ØB1 ØB2

Standard Bores

Coupling Size	Bore Size										
	+ 0.03 / - 0 mm										
	3	3.175	4	4.763	5	6	6.350	7.938	8	9	9.525
16	●	●	●	●	●	●	●				
19			●	●	●	●	●		●		
25					●	●	●	●	●	●	●
32						●	●	●	●	●	●
38											●
50											
Bore ref.	14	16	18	19	20	22	24	27	28	30	31

● B1 only

● B1 & B2

3.52



Unit 14, Foxwood Industrial Park, Foxwood Rd. Chesterfield, Derbyshire S41 9RN

Telephone +44(0)1246 268080 Fax +44(0)1246 260003

Material

Stainless Steel

Couplings

Single Beam

DISCOUNTS

1 - 19	20-39	40-59	60-99	100 +
List Price	-15%	-20%	-25%	-30%

PART NUMBER		Fasteners				Mass Kg $\times 10^{-3}$	PRICE EACH 1-19
Set Screw Hubs	Clamp Hubs	Set Screw	Cap Screw	Torque (Nm)	A/F (mm)		
HPC820.16.----	-	M4	-	1.05	2.0	25.6	£39.48
-	HPC821.16.----	-	M2.5	0.68	2.0	26.0	£53.16
HPC820.19.----	-	M4	-	1.05	2.0	35.8	£44.31
-	HPC821.19.----	-	M2.5	0.68	2.0	47.7	£59.90
HPC820.25.----	-	M5	-	2.10	2.5	78	£59.99
-	HPC821.25.----	-	M3	1.20	2.5	91	£77.09
HPC820.32.----	-	M6	-	3.75	3.0	152	£92.26
-	HPC821.32.----	-	M4	2.85	3.0	186	£113.35
HPC820.38.----	-	M6	-	3.75	3.0	365	£146.64
-	HPC821.38.----	-	M5	5.85	4.0	350	£180.54
HPC820.50.----	-	M8	-	9.00	4.0	680	£193.60
-	HPC821.50.----	-	M6	9.75	5.0	660	£264.03

Couplings Single Beam

Coupling Size	Bore Size + 0.03 / - 0 mm										
	10	12	12.7	14	15	15.875	16	19.050	20	24	25
16											
19											
25	●										
32	●	●	●	●	●	●					
38	●	●	●	●	●	●	●				
50			●	●	●	●	●	●	●	●	●
<i>Bore ref.</i>	32	35	36	38	40	41	42	47	48	52	53

