

# STH Helical Pinion Shafts - CP Materials

## DSTH

17° 45' H.A.  
20° P.A.

STD : Stainless Steel 303S21/3 (En58)

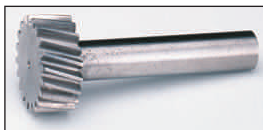

**STH** Single



**DSTH** Double

### Single sided

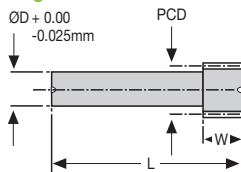

### Double sided

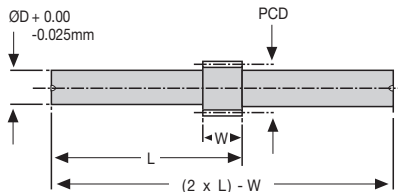

Right Hand as standard.

Other numbers of teeth available,  
please see gear section.

### DISCOUNTS

1 - 5	List Price
6 - 19	- 12%
20 - 39	- 25%
40 - 59	- 33%
60 - 99	- 37%
100 - 200	- 42%

\* CORRECTED

PART NUMBER	PITCH CP (ins)	TEETH	PCD	L (mm)	W (mm)	ØD (mm)	PRICE EACH 1 - 5	
							STH	DSTH
STH20-10	0.050	10 *	4.67	30	6	4	£20.47	£30.77
STH20-12	0.050	12 *	5.52	30	6	4	£22.29	£33.44
STH20-15	0.050	15 *	6.79	30	6	4	£24.37	£36.55
STH20-20	0.050	20	8.49	40	6	6	£25.36	£38.09
STH20-25	0.050	25	10.61	40	6	6	£26.70	£40.17
STH20-30	0.050	30	12.73	50	6	6	£29.10	£43.73
STH20-50	0.050	50	21.22	50	6	6	£40.78	£61.25
STH10-10	0.100	10 *	9.34	50	8	8	£27.13	£40.75
STH10-12	0.100	12 *	11.04	50	8	8	£30.86	£46.36
STH10-15	0.100	15 *	13.58	50	8	8	£32.75	£49.21
STH10-20	0.100	20	16.98	60	8	10	£35.36	£53.14
STH10-25	0.100	25	21.22	70	8	10	£42.65	£64.06
STH10-30	0.100	30	25.47	70	8	10	£54.24	£81.43
STH10-50	0.100	50	42.45	70	8	10	£81.38	£122.15

Pinions & Shafts PITCH 0.050" / 0.100"



# Materials Helical Pinion Shafts - CP STH

STD : Stainless Steel 303S21/3 (En58)

17° 45' H.A.  
20° P.A.

DSTH

## Single sided

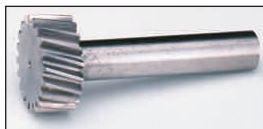
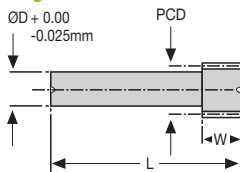

STH Single

## Double sided

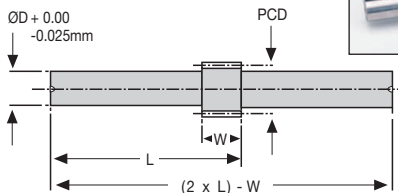

DSTH Double

Right Hand as standard.

## DISCOUNTS

	List Price
1 - 5	- 12%
6 - 19	- 25%
20 - 39	- 33%
40 - 59	- 37%
60 - 99	- 42%
100 - 200	- 42%

Other numbers of teeth available, please see gear section.

\* CORRECTED

PART NUMBER	PITCH CP (mm)	TEETH	PCD	L (mm)	W (mm)	ØD (mm)	PRICE EACH 1 - 5	
							STH	DSTH
STH1-10	1	10 *	3.68	25	6	3	£20.47	£30.77
STH1-12	1	12 *	4.34	25	6	3	£22.29	£33.44
STH1-15	1	15 *	5.35	25	6	3	£24.37	£36.55
STH1-20	1	20	6.68	30	6	5	£25.36	£38.09
STH1-25	1	25	8.36	40	6	5	£26.70	£40.17
STH1-30	1	30	10.03	40	6	5	£29.10	£43.73
STH1-50	1	50	16.71	40	6	5	£40.78	£61.25
STH2-10	2	10 *	7.35	50	8	6	£27.13	£40.75
STH2-12	2	12 *	8.69	50	8	6	£30.86	£46.36
STH2-15	2	15 *	10.70	50	8	6	£32.75	£49.21
STH2-20	2	20	13.37	60	8	8	£35.36	£53.14
STH2-25	2	25	16.71	60	8	8	£42.65	£64.06
STH2-30	2	30	20.05	60	8	8	£54.24	£81.43
STH2-50	2	50	33.42	60	8	8	£81.38	£122.15

