

Anti-backlash Wormwheels Materials

24 DP

STD : Phosphor Bronze PB2
SPECIAL TEETH : between 48 - 150

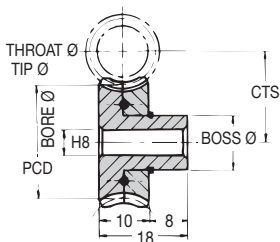

20° Pressure Angle

TORQUE CHECK	50 TEETH x 1000 R.P.M. INPUT
variations at back	with std worm
TORQUE Nm	0.576
K.W.	0.0092

DISCOUNTS

Quantity	List Price
1 - 5	
6 - 19	- 12%
20 - 39	- 25%
40 - 59	- 33%
60 - 99	- 37%
100 - 200	- 42%

Anti-backlash Wormwheels

DP 24

PART NUMBER	TEETH	PCD (ins)	CTS (ins)	THROAT Ø (ins)	TIP Ø (ins)	BOSS Ø (ins)	BORE Ø (ins)	PRICE EACH 1-5
ABM24-48	48	2.000	1.313	2.083	2.125	0.750	0.375	£84.56
ABM24-50	50	2.083	1.354	2.167	2.208	0.750	0.375	£87.80
ABM24-52	52	2.167	1.396	2.250	2.292	0.750	0.375	£91.04
ABM24-54	54	2.250	1.438	2.333	2.375	0.750	0.375	£94.23
ABM24-55	55	2.292	1.458	2.375	2.417	0.750	0.375	£97.42
ABM24-58	58	2.417	1.521	2.500	2.542	0.750	0.375	£100.69
ABM24-60	60	2.500	1.563	2.583	2.625	0.750	0.375	£103.90
ABM24-62	62	2.583	1.604	2.667	2.708	0.750	0.375	£107.92
ABM24-64	64	2.667	1.646	2.750	2.792	0.750	0.375	£111.94
ABM24-65	65	2.708	1.667	2.792	2.833	0.750	0.375	£115.97
ABM24-68	68	2.833	1.729	2.917	2.958	0.750	0.375	£119.99
ABM24-70	70	2.917	1.771	3.000	3.042	0.750	0.375	£124.01
ABM24-72	72	3.000	1.813	3.083	3.125	0.750	0.375	£127.95
ABM24-75	75	3.125	1.875	3.208	3.250	0.750	0.375	£131.76
ABM24-78	78	3.250	1.938	3.333	3.375	0.750	0.375	£135.55
ABM24-80	80	3.333	1.979	3.417	3.458	0.750	0.375	£139.33
ABM24-82	82	3.417	2.021	3.500	3.542	0.750	0.375	£143.15
ABM24-85	85	3.542	2.083	3.625	3.667	0.750	0.375	£146.93
ABM24-88	88	3.667	2.146	3.750	3.792	0.750	0.375	£150.79
ABM24-90	90	3.750	2.188	3.833	3.875	0.750	0.375	£154.51
ABM24-94	94	3.917	2.271	4.000	4.042	0.750	0.375	£161.82
ABM24-96	96	4.000	2.313	4.083	4.125	0.750	0.375	£169.12
ABM24-100	100	4.167	2.396	4.250	4.292	0.750	0.375	£176.46
ABM24-110	110	4.583	2.604	4.667	4.708	1.000	0.500	£220.99
ABM24-120	120	5.000	2.813	5.083	5.125	1.000	0.500	£265.50
ABM24-150	150	6.250	2.438	6.333	6.375	1.000	0.500	£370.30

16.12



Unit 14, Foxwood Ind. Park, Foxwood Rd. Chesterfield, Derbyshire S41 9RN
Telephone +44(0)1246 268080 Fax +44(0)1246 260003