

Materials **Anti-backlash Wormwheels**

STD : Phosphor Bronze PB₂

SPECIAL TEETH : between 48 - 150

32 DP

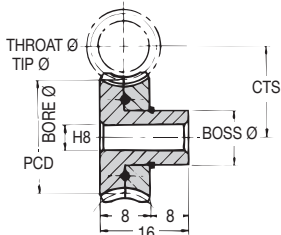

DISCOUNTS

1 - 5	List Price
6 - 19	- 12%
20 - 39	- 25%
40 - 59	- 33%
60 - 99	- 37%
100 - 200	- 42%

TORQUE CHECK	50 TEETH x 1000 R.P.M. INPUT
variations at back	with std worm
TORQUE Nm	0.288
K.W.	0.00616

20° Pressure Angle

PART NUMBER	TEETH	PCD (ins)	CTS (ins)	THROAT Ø (ins)	TIP Ø (ins)	BOSS Ø (ins)	BORE Ø (ins)	PRICE EACH 1-5
ABM32-48	48	1.500	1.000	1.563	1.594	0.625	0.250	£57.26
ABM32-50	50	1.563	1.031	1.625	1.656	0.625	0.250	£59.49
ABM32-52	52	1.625	1.063	1.688	1.719	0.625	0.250	£61.72
ABM32-54	54	1.688	1.094	1.750	1.781	0.625	0.250	£63.91
ABM32-55	55	1.719	1.109	1.781	1.813	0.625	0.250	£66.12
ABM32-58	58	1.813	1.156	1.875	1.906	0.625	0.250	£68.34
ABM32-60	60	1.875	1.188	1.938	1.969	0.625	0.250	£70.57
ABM32-62	62	1.938	1.219	2.000	2.031	0.625	0.250	£72.73
ABM32-64	64	2.000	1.250	2.063	2.094	0.750	0.312	£76.12
ABM32-65	65	2.031	1.266	2.094	2.125	0.750	0.312	£79.52
ABM32-68	68	2.125	1.313	2.188	2.219	0.750	0.312	£82.87
ABM32-70	70	2.188	1.344	2.250	2.281	0.750	0.312	£86.23
ABM32-72	72	2.250	1.375	2.313	2.344	0.750	0.312	£89.65
ABM32-75	75	2.344	1.422	2.406	2.438	0.750	0.312	£92.98
ABM32-78	78	2.438	1.469	2.500	2.531	0.750	0.312	£95.39
ABM32-80	80	2.500	1.500	2.563	2.594	0.750	0.312	£97.92
ABM32-82	82	2.563	1.531	2.625	2.656	0.750	0.312	£100.38
ABM32-85	85	2.656	1.578	2.719	2.750	0.750	0.312	£102.83
ABM32-88	88	2.750	1.625	2.813	2.844	0.750	0.312	£105.31
ABM32-90	90	2.813	1.656	2.875	2.906	0.750	0.312	£107.74
ABM32-94	94	2.938	1.719	3.000	3.031	0.750	0.312	£110.25
ABM32-96	96	3.000	1.750	3.063	3.094	0.750	0.312	£112.74
ABM32-100	100	3.125	1.813	3.188	3.219	0.750	0.312	£117.45
ABM32-110	110	3.438	1.969	3.500	3.531	0.750	0.312	£122.15
ABM32-120	120	3.750	2.125	3.813	3.844	0.750	0.312	£126.87
ABM32-150	150	4.688	2.594	4.750	4.781	0.750	0.312	£153.14

Anti-backlash

Wormwheels DP 32

Unit 14, Foxwood Ind. Park, Foxwood Rd. Chesterfield, Derbyshire S41 9RN

Telephone +44(0)1246 268080 Fax +44(0)1246 260003



16.11