

# Gearboxes

Output Torque Range  
5Nm to 18Nm

Ratio  
5:1 - 120:1

Worm / Wheel Reduction

Shaft Input

HPCP40

Gearboxes PRECISION WORM GEAR REDUCERS HPCP40



|                         |                    |
|-------------------------|--------------------|
| <b>WEIGHT</b>           | 0.92 Kg            |
| <b>BACKLASH</b>         | 0° 30'             |
| <b>HOURS LIFE</b>       | 12000 hr           |
| <b>MAX INPUT SPEED</b>  | 4000 rpm           |
| <b>MATERIAL:</b>        |                    |
| <b>CASE MAT'L</b>       | Aluminium HE30TF   |
| <b>WORM MAT'L</b>       | 817M40(EN24)       |
| <b>WHEEL MAT'L</b>      | Alum. Bronze (AB2) |
| <b>GREASED FOR LIFE</b> | Shell Gadus        |

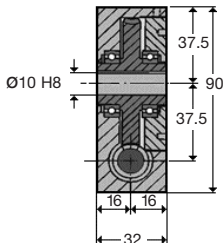
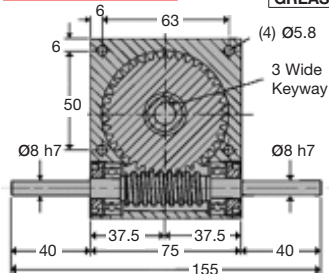

| N.m.          | RPM Input | Reduction ratio |      |      |      |      |      |
|---------------|-----------|-----------------|------|------|------|------|------|
|               |           | 10:1            | 12:1 | 15:1 | 20:1 | 30:1 | 60:1 |
| Output Torque | 3000      | 5.0             | 5.2  | 5.4  | 5.6  | 6.4  | 7.2  |
|               | 2000      | 5.5             | 5.8  | 6.2  | 6.6  | 7.3  | 8.0  |
|               | 1000      | 7.1             | 7.5  | 8.0  | 8.2  | 9.0  | 10.0 |
|               | 500       | 8.9             | 9.1  | 9.6  | 10.0 | 10.5 | 11.4 |
|               | 200       | 11.6            | 11.9 | 12.3 | 12.5 | 13.5 | 14.2 |
|               | 100       | 13.4            | 13.6 | 14.1 | 14.6 | 15.3 | 16.0 |
|               | 50        | 15.1            | 15.5 | 16.2 | 16.4 | 17.3 | 17.6 |
|               | 10        | 17.6            | 17.6 | 17.6 | 17.7 | 17.8 | 18.0 |

| DISCOUNTS |            |
|-----------|------------|
| 1 - 5     | List Price |
| 6 - 19    | -5%        |
| 20 - 49   | -10%       |
| 50 - 99   | -15%       |
| 100 +     | -20%       |

| PART NUMBER | Ratio                                 | Max Input Speed | Max Output Speed | % Effi. at 1000 Rpm | Backdrive | PRICE EACH 1-5 |
|-------------|---------------------------------------|-----------------|------------------|---------------------|-----------|----------------|
| HPCP40-10   | 10:1                                  | 4000            | 400              | 89                  | YES       | £207.03        |
| HPCP40-12   | 12:1                                  | 4000            | 333              | 87                  | YES       | £207.03        |
| HPCP40-15   | 15:1                                  | 4000            | 266              | 85                  | YES       | £207.03        |
| HPCP40-20   | 20:1                                  | 4000            | 200              | 83                  | YES       | £207.03        |
| HPCP40-30   | 30:1                                  | 4000            | 133              | 76                  | YES/NO    | £207.03        |
| HPCP40-60   | 60:1                                  | 4000            | 66               | 65                  | NO        | £207.03        |
| HPCP40-S    | 5:1-120:1 SPECIAL RATIO               |                 |                  |                     |           | £274.76        |
| HPCP40-A    | SPECIAL MINIMUM BACKLASH 0° 8' OF ARC |                 |                  |                     |           | £327.09        |

Output Shafts: HPCP40-X (Single), HPCP40-DX (Double): See page 1.23.

Testing in your application is necessary. You will need to assess duty, cycles and confirm gearbox suitability with your own calculations. Torque figures are to be used for guidance only.

1.8



Unit 14, Foxwood Industrial Park, Foxwood Rd. Chesterfield, Derbyshire S41 9RN

Telephone +44(0)1246 268080 Fax +44(0)1246 260003