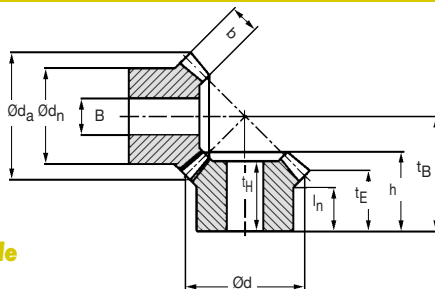

**Mitre Bevel 1:1****Materials****1.0-6.0 MOD**

STD : Steel 080M40 (En8)

BS545

**20° Pressure Angle****Gear Life : 12,000 hours (based on 12 hours per day usage)****DISCOUNTS**

Quantity	List Price
1 - 5	-
6 - 19	- 5%
20 - 39	- 10%
40 - 59	- 15%
60 - 99	- 20%
100 - 200	- 30%

TORQUE CHECK	16 teeth x 1000 rpm									
	1.0 MOD	1.5 MOD	2.0 MOD	2.5 MOD	3.0 MOD	3.5 MOD	4.0 MOD	4.5 MOD	5.0 MOD	6.0 MOD
TORQUE Nm.	0.28	0.92	1.85	3.50	5.56	8.50	12.20	16.80	22	30.60
K.W.	0.029	0.097	0.19	0.37	0.58	0.89	1.28	1.76	2.30	3.20

PART NUMBER	No. of TEETH	MOD	$d_a$	$d$	$b$	$h_n$	$d_n$	$B$	$t_B$	$h$	$t_H$	$t_E$	Weight kg	PRICE EA, 1-5
151-110-016	16	1.0	17.41	16.0	4.0	8.0	14.0	5.0	17.0	12.3	11.0	9.71	0.012	<b>£26.65</b>
151-110-019	19		20.41	19.0	4.5	8.0	16.0	6.0	19.0	13.1	12.0	10.21	0.018	<b>£32.52</b>
151-110-022	22		23.41	22.0	5.0	9.5	19.0	6.0	22.0	15.0	13.5	11.71	0.027	<b>£40.18</b>
151-110-026	26	1.5	27.41	26.0	6.0	10.0	22.0	8.0	25.0	16.7	15.5	12.71	0.042	<b>£45.56</b>
151-110-030	30		31.41	30.0	7.0	10.5	25.0	8.0	28.0	18.4	17.0	13.71	0.061	<b>£53.87</b>
151-115-016	16		26.11	24.0	6.0	10.0	20.0	8.0	24.0	16.9	15.0	13.06	0.032	<b>£33.36</b>
151-115-019	19	2.0	30.62	28.5	6.5	10.5	24.0	8.0	27.0	18.0	16.0	13.81	0.053	<b>£42.15</b>
151-115-022	22		35.12	33.0	7.5	11.0	26.0	8.0	31.0	20.5	18.5	15.56	0.077	<b>£48.80</b>
151-115-026	26		41.11	39.0	8.5	13.0	28.0	10.0	35.0	22.2	20.5	16.56	0.105	<b>£59.09</b>
151-115-030	30	2.5	47.12	45.0	10.0	13.5	30.0	10.0	39.0	24.3	22.5	17.56	0.150	<b>£57.03</b>
151-120-016	16		34.82	32.0	8.0	12.0	26.0	10.0	31.0	21.5	19.0	16.41	0.072	<b>£43.59</b>
151-120-019	19		40.82	38.0	9.0	12.0	30.0	10.0	35.0	23.2	21.0	17.41	0.115	<b>£53.53</b>
151-120-022	22	3.0	46.82	44.0	10.0	13.0	32.0	12.0	39.0	25.0	23.0	18.41	0.155	<b>£59.09</b>
151-120-026	26		54.82	52.0	11.5	14.0	36.0	12.0	45.0	28.0	26.0	20.41	0.242	<b>£70.00</b>
151-120-030	30		62.82	60.0	13.5	15.0	40.0	14.0	50.0	30.4	28.0	21.41	0.340	<b>£78.79</b>
151-125-016	16	3.5	43.53	40.0	10.0	13.0	32.0	12.0	37.0	25.0	22.0	18.77	0.132	<b>£51.08</b>
151-125-019	19		51.03	47.5	11.0	14.5	38.0	12.0	43.0	28.1	25.0	21.02	0.220	<b>£62.49</b>
151-125-022	22		58.53	55.0	12.5	16.0	40.0	14.0	48.0	30.4	28.0	22.27	0.298	<b>£68.01</b>
151-125-026	26	4.0	68.53	65.0	14.5	17.0	45.0	16.0	54.0	32.8	30.0	23.27	0.433	<b>£78.79</b>
151-125-030	30		78.53	75.0	16.5	18.0	50.0	18.0	60.0	35.3	32.0	24.27	0.602	<b>£89.69</b>

**226**

Unit 14, Foxwood Industrial Park, Foxwood Road, Chesterfield, Derbyshire S41 9RN

Telephone +44(0)1246 268080

Fax +44(0)1246 260003



**Bevel Gears 1.5:1****Materials****1.0 - 6.0 MOD**

STD : Steel 080M40 (En8)

BS545

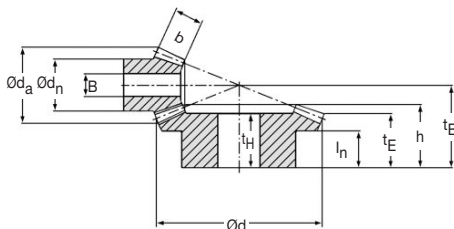
**20° Pressure Angle****Straight Teeth.****Angle of Engagement : 90°****Gear Life : 12,000 hours (based on 12 hours per day usage)****DISCOUNTS**

1 - 5	List Price
6 - 19	- 5%
20 - 39	- 10%
40 - 59	- 15%
60 - 99	- 20%
100 - 200	- 30%

TORQUE CHECK	16 teeth x 1000 rpm									
	1.0 MOD	1.5 MOD	2.0 MOD	2.5 MOD	3.0 MOD	3.5 MOD	4.0 MOD	4.5 MOD	5.0 MOD	6.0 MOD
TORQUE Nm.	0.33	1.10	2.20	4.14	6.62	10.10	14.50	20.00	26.20	36.40
K.W.	0.035	0.12	0.23	0.43	0.71	1.06	1.50	2.11	2.75	3.82

PART NUMBER	No. of TEETH	MOD	d <sub>a</sub>	d	b	l <sub>h</sub>	d <sub>n</sub>	B	t <sub>g</sub>	h	t <sub>h</sub>	t <sub>E</sub>	Weight kg	PRICE EA. 1-5
151-210-016	16	1.0	17.66	16.0	4.5	7.2	13.5	5.0	20.0	12.2	11.0	8.55	0.011	<b>£28.28</b>
151-210-024	24		25.11	24.0	4.5	9.3	21.0	6.0	20.0	15.1	13.5	12.83	0.035	<b>£42.46</b>
151-215-016	16	1.5	26.49	24.0	7.0	10.6	20.0	8.0	30.0	18.4	17.0	12.83	0.036	<b>£38.22</b>
151-215-024	24		37.67	36.0	7.0	12.0	26.0	8.0	27.0	19.7	17.5	16.25	0.080	<b>£57.46</b>
151-220-016	16	2.0	35.32	32.0	10.0	12.0	26.0	10.0	38.0	23.0	21.0	15.17	0.080	<b>£47.17</b>
151-220-024	24		50.22	48.0	10.0	15.0	35.0	12.0	35.0	25.7	23.0	20.66	0.185	<b>£70.80</b>
151-225-016	16	2.5	44.16	40.0	12.5	13.5	32.0	12.0	46.0	27.3	25.0	17.40	0.146	<b>£53.05</b>
151-225-024	24		62.77	60.0	12.5	16.0	42.0	14.0	42.0	30.2	27.0	24.10	0.340	<b>£79.45</b>
151-230-016	16	3.0	53.00	48.0	14.5	15.5	40.0	14.0	54.0	31.1	28.0	19.66	0.255	<b>£61.02</b>
151-230-024	24		75.32	72.0	14.5	18.0	50.0	16.0	49.0	34.6	30.0	27.50	0.555	<b>£92.17</b>
151-235-016	16	3.5	61.82	56.0	17.0	17.0	47.0	16.0	62.0	35.4	32.0	21.94	0.400	<b>£70.95</b>
151-235-024	24		87.88	84.0	17.0	21.0	58.0	18.0	57.0	40.3	36.0	31.91	0.905	<b>£105.66</b>
151-240-016	16	4.0	70.65	64.0	19.0	18.5	54.0	18.0	70.0	39.2	35.0	24.21	0.584	<b>£77.97</b>
151-240-024	24		100.43	96.0	19.0	24.0	66.0	20.0	65.0	45.7	40.0	36.32	1.330	<b>£117.72</b>
151-245-016	16	4.5	79.48	72.0	21.5	21.0	60.0	20.0	79.0	44.5	40.0	27.50	0.833	<b>£103.53</b>
151-245-024	24		113.00	108.0	21.5	26.0	75.0	25.0	73.0	51.5	45.0	40.74	1.880	<b>£154.53</b>
151-250-016	16	5.0	88.32	80.0	24.0	23.0	65.0	22.0	88.0	49.8	45.0	30.77	1.130	<b>£104.35</b>
151-250-024	24		125.54	120.0	24.0	28.0	85.0	30.0	80.0	56.0	49.0	44.16	2.550	<b>£156.16</b>
151-260-016	16	6.0	105.96	96.0	28.5	24.7	80.0	25.0	102.0	55.9	50.0	33.33	2.050	<b>£221.64</b>
151-260-024	24		150.66	144.0	28.5	32.0	105.0	35.0	90.0	61.1	52.5	46.99	4.180	<b>£300.13</b>

**228**

Unit 14, Foxwood Industrial Park, Foxwood Road, Chesterfield, Derbyshire S41 9RN

Telephone +44(0)1246 268080

Fax +44(0)1246 260003

**Materials**

STD : Steel 080M40 (En8)  
B5545

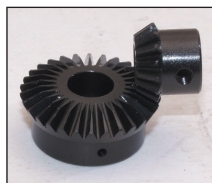
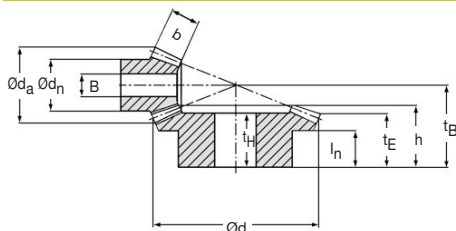
**Bevel Gears 2:1****1.0-6.0 MOD****20° Pressure Angle****Straight Teeth.****Angle of Engagement : 90°****Gear Life : 12,000 hours (based on 12 hours per day usage)****DISCOUNTS**

	List Price
1 - 5	- 5%
6 - 19	- 10%
20 - 39	- 15%
40 - 59	- 20%
60 - 99	- 25%
100 - 200	- 30%

TORQUE CHECK	16 teeth x 1000 rpm									
	1.0 MOD	1.5 MOD	2.0 MOD	2.5 MOD	3.0 MOD	3.5 MOD	4.0 MOD	4.5 MOD	5.0 MOD	6.0 MOD
TORQUE Nm.	0.31	1.02	2.37	4.68	7.56	11.50	16.50	23.20	31.30	50.50
K.W.	0.032	0.11	0.25	0.49	0.79	1.21	1.73	2.43	3.28	5.29

PART NUMBER	No. of TEETH	MOD	da	d	b	lH	dn	B	tB	h	tH	tE	Weight kg	PRICE EA.
														1-5
151-310-015	15	1.0	16.79	15.0	5.0	8.0	12.5	5.0	23.0	12.8	12.0	8.45	0.010	£24.22
151-310-030	30		30.89	30.0	5.0	9.0	22.0	8.0	20.0	15.4	14.0	13.40	0.044	£58.25
151-315-015	15	1.5	25.19	22.5	8.0	10.6	19.0	8.0	34.0	19.1	18.0	12.17	0.032	£26.49
151-315-030	30		46.34	45.0	8.0	13.0	32.0	10.0	28.0	21.2	19.0	18.09	0.133	£58.25
151-320-015	15	2.0	33.58	30.0	11.5	12.0	25.0	10.0	43.0	23.8	22.0	13.89	0.071	£44.08
151-320-030	30		61.80	60.0	11.5	15.0	40.0	14.0	35.0	26.3	23.0	21.79	0.278	£88.22
151-325-015	15	2.5	41.98	37.5	14.5	14.0	31.0	12.0	53.0	29.2	27.0	16.62	0.140	£48.49
151-325-030	30		77.25	75.0	14.5	17.0	50.0	18.0	42.0	30.9	27.0	25.49	0.510	£97.35
151-330-015	15	3.0	50.37	45.0	17.0	16.0	38.0	14.0	63.0	34.0	32.0	19.34	0.245	£51.25
151-330-030	30		92.70	90.0	17.0	19.0	60.0	20.0	49.0	35.8	31.0	29.18	0.880	£103.41
151-335-015	15	3.5	58.77	52.5	19.5	18.5	44.0	16.0	73.0	38.9	36.0	22.06	0.380	£64.93
151-335-030	30		108.15	106.0	19.5	22.0	70.0	22.0	57.0	41.5	36.0	33.88	1.410	£130.42
151-340-015	15	4.0	67.16	60.0	22.0	25.0	50.0	18.0	83.0	43.8	41.0	24.79	0.560	£76.35
151-340-030	30		123.60	120.0	22.0	25.0	80.0	25.0	65.0	47.1	42.0	38.58	2.130	£152.57
151-345-015	15	4.5	75.56	67.5	25.0	22.5	55.0	20.0	93.0	49.2	46.0	27.51	0.780	£93.77
151-345-030	30		139.02	135.0	25.0	28.0	90.0	30.0	73.0	53.0	47.0	43.27	2.990	£187.60
151-350-015	15	5.0	83.95	75.0	28.0	24.0	60.0	22.0	103.0	54.5	51.0	30.23	1.060	£95.73
151-350-030	30		154.46	150.0	28.0	30.0	100.0	25.0	80.0	57.9	51.0	46.97	3.980	£191.99
151-360-015	15	6.0	100.74	90.0	32.5	26.2	75.0	25.0	120.0	60.8	56.0	32.68	1.820	£232.54
151-360-030	30		185.34	180.0	32.5	33.0	120.0	40.0	90.0	63.2	54.0	50.37	5.840	£463.37

Unit 14, Foxwood Industrial Park, Foxwood Road, Chesterfield, Derbyshire S41 9RN

Telephone +44(0)1246 268080 Fax +44(0)1246 260003

**229****Bevel Gears Steel MOD 1:6**

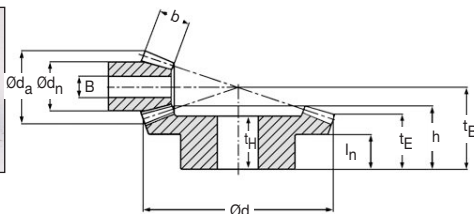
**Bevel Gears 2.5:1****Materials****1.0-6.0 MOD**STD : Steel 080M40 (En8)  
BS545**20° Pressure Angle****Straight Teeth.****Angle of Engagement : 90°****Gear Life : 12,000 hours (based on 12 hours per day usage)****Bevel Gears Steel MOD 1-6****DISCOUNTS**

1-5	List Price
6-19	- 5%
20-39	- 10%
40-59	- 15%
60-99	- 20%
100-200	- 30%

TORQUE CHECK	16 teeth x 1000 rpm									
	1.0 MOD	1.5 MOD	2.0 MOD	2.5 MOD	3.0 MOD	3.5 MOD	4.0 MOD	4.5 MOD	5.0 MOD	6.0 MOD
TORQUE Nm.	0.36	1.21	2.92	5.32	8.36	12.60	17.70	24.20	33	45.70
K.W.	0.038	0.13	0.31	0.56	0.88	1.32	1.86	2.53	3.45	4.79

PART NUMBER	No. of TEETH	MOD	d <sub>a</sub>	d	b	l <sub>n</sub>	d <sub>n</sub>	B	t <sub>B</sub>	h	t <sub>H</sub>	t <sub>E</sub>	Weight kg	PRICE EA. 1-5
151-410-016	16	1.0	17.86	16.0	6.0	7.5	13.5	5.0	28.0	13.8	13.0	8.37	0.013	£29.75
151-410-040	40		40.74	40.0	6.0	9.0	25.0	8.0	21.0	15.9	14.0	13.93	0.075	£73.56
151-415-016	16	1.5	26.79	24.0	9.0	11.2	20.0	8.0	42.0	20.7	19.5	12.56	0.041	£36.92
151-415-040	40		61.11	60.0	9.0	13.5	38.0	12.0	30.0	22.3	20.0	19.39	0.232	£92.17
151-420-016	16	2.0	35.71	32.0	13.5	14.0	26.0	12.0	55.0	28.0	26.0	15.74	0.091	£40.98
151-420-040	40		81.48	80.0	13.5	18.0	50.0	18.0	39.0	29.2	26.0	24.85	0.515	£103.53
151-425-016	16	2.5	44.64	40.0	17.0	15.5	32.0	14.0	67.0	33.4	32.0	17.93	0.174	£53.20
151-425-040	40		101.85	100.0	17.0	20.0	60.0	20.0	46.0	33.9	30.0	28.32	0.930	£132.37
151-430-016	16	3.0	53.56	48.0	20.0	17.5	40.0	16.0	79.0	38.3	36.0	20.11	0.305	£61.83
151-430-040	40		122.22	120.0	20.0	23.0	70.0	22.0	55.0	40.3	36.0	33.78	1.630	£154.53
151-435-016	16	3.5	62.49	56.0	23.5	19.0	45.0	18.0	91.0	43.6	41.0	22.30	0.470	£73.56
151-435-040	40		142.59	140.0	23.5	26.0	80.0	25.0	62.0	44.7	40.0	37.25	2.370	£183.68
151-440-016	16	4.0	71.42	64.0	27.0	21.5	52.0	20.0	104.0	50.0	47.0	25.48	0.720	£88.22
151-440-040	40		162.97	160.0	27.0	30.0	90.0	30.0	72.0	52.5	46.0	43.71	3.560	£220.80
151-445-016	16	4.5	80.35	72.0	30.0	23.5	60.0	22.0	116.0	54.9	52.0	27.67	1.040	£117.72
151-445-040	40		183.34	180.0	30.0	34.0	100.0	35.0	81.0	59.0	52.0	49.18	4.980	£294.12
151-450-016	16	5.0	89.28	80.0	33.0	26.0	65.0	25.0	129.0	60.8	58.0	30.86	1.370	£132.54
151-450-040	40		203.71	200.0	33.0	36.0	110.0	40.0	88.0	63.4	56.0	52.64	6.600	£330.13
151-460-016	16	6.0	107.16	96.0	36.5	26.8	80.0	25.0	150.0	65.5	62.0	32.23	2.480	£291.36
151-460-040	40		244.44	240.0	36.5	34.0	125.0	40.0	95.0	64.5	55.0	52.57	12.350	£737.98

**230**Unit 14, Foxwood Industrial Park, Foxwood Road, Chesterfield, Derbyshire S41 9RN  
Telephone +44(0)1246 268080 Fax +44(0)1246 260003

**Materials**

STD : Steel 080M40 (En8)  
B5545

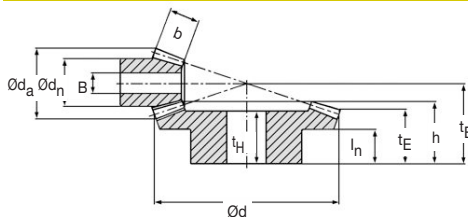
**Bevel Gears 3:1****1.0-6.0 MOD****20° Pressure Angle****Straight Teeth.****Angle of Engagement : 90°****Gear Life : 12,000 hours (based on 12 hours per day usage)****DISCOUNTS**

1 - 5	List Price
6 - 19	- 5%
20 - 39	- 10%
40 - 59	- 15%
60 - 99	- 20%
100 - 200	- 30%

TORQUE CHECK	16 teeth x 1000 rpm									
	1.0 MOD	1.5 MOD	2.0 MOD	2.5 MOD	3.0 MOD	3.5 MOD	4.0 MOD	4.5 MOD	5.0 MOD	6.0 MOD
TORQUE Nm.	0.33	1.09	2.64	5.13	7.55	11.30	16.06	22.20	29.70	41.10
K.W.	0.034	0.11	0.28	0.54	0.79	1.18	1.70	2.33	3.11	4.30

PART NUMBER	No. of TEETH	MOD	d <sub>a</sub>	d	b	l <sub>H</sub>	d <sub>n</sub>	B	t <sub>B</sub>	h	t <sub>H</sub>	t <sub>E</sub>	Weight kg	PRICE EA. 1-5
151-510-015	15	1.0	16.90	15.0	7.0	8.0	12.5	5.0	31.0	15.4	14.5	8.82	0.012	£24.22
151-510-045	45	1.0	45.63	45.0	7.0	10.0	28.0	10.0	22.0	17.4	15.5	15.45	0.102	£72.77
151-515-015	15	1.5	25.35	22.5	10.0	11.6	19.0	8.0	46.0	22.1	21.0	12.72	0.039	£26.49
151-515-045	45	1.5	68.45	67.5	10.0	14.5	40.0	14.0	31.0	23.9	21.5	21.17	0.300	£79.45
151-520-015	15	2.0	33.79	30.0	14.0	14.0	25.0	12.0	60.0	28.7	27.0	15.63	0.082	£47.17
151-520-045	45	2.0	91.26	90.0	14.0	20.0	50.0	18.0	41.0	31.7	28.0	27.89	0.632	£142.30
151-525-015	15	2.5	42.24	37.5	17.5	15.5	31.0	14.0	73.0	33.8	32.0	17.54	0.155	£46.70
151-525-045	45	2.5	114.08	112.5	17.5	22.0	60.0	20.0	48.0	36.4	32.0	31.62	1.150	£140.69
151-530-015	15	3.0	50.68	45.0	21.0	17.5	38.0	16.0	86.0	39.0	37.0	19.45	0.275	£55.51
151-530-045	45	3.0	136.89	135.0	21.0	25.0	70.0	22.0	56.0	42.1	37.0	36.34	1.900	£167.25
151-535-015	15	3.5	59.13	52.5	24.5	20.0	44.0	18.0	100.0	45.2	43.0	22.35	0.440	£84.62
151-535-045	45	3.5	159.71	157.5	24.5	28.0	80.0	25.0	64.0	47.8	42.0	41.07	2.950	£193.63
151-540-015	15	4.0	67.58	60.0	28.0	22.5	50.0	20.0	114.0	51.4	49.0	25.26	0.650	£77.14
151-540-045	45	4.0	182.52	180.0	28.0	32.0	90.0	30.0	73.0	54.5	48.0	46.79	4.320	£231.88
151-545-015	15	4.5	73.03	67.5	31.0	24.5	55.0	22.0	128.0	57.1	54.0	28.17	0.910	£99.62
151-545-045	45	4.5	205.34	202.5	31.0	35.0	105.0	35.0	81.0	60.1	53.0	51.52	6.180	£299.67
151-550-015	15	5.0	84.48	75.0	34.0	27.0	60.0	25.0	142.0	62.8	60.0	31.80	1.210	£121.44
151-550-045	45	5.0	228.16	225.0	34.0	38.0	120.0	40.0	89.0	65.6	58.0	56.24	8.660	£366.28
151-560-015	15	6.0	101.40	90.0	41.0	27.5	75.0	25.0	165.0	70.2	66.0	31.89	2.420	£310.74
151-560-045	45	6.0	273.78	270.0	41.0	35.0	140.0	45.0	98.0	70.0	60.0	58.69	17.510	£481.35

Unit 14, Foxwood Industrial Park, Foxwood Road, Chesterfield, Derbyshire S41 9RN

Telephone +44(0)1246 268080 Fax +44(0)1246 260003

**231****Bevel Gears Steel MOD 1-6**

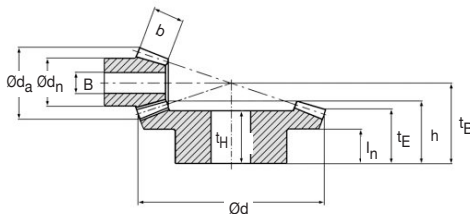
**Bevel Gears 4:1****Materials****1.0-6.0 MOD**STD : Steel 080M40 (En8)  
BS545**20° Pressure Angle****Straight Teeth.****Angle of Engagement : 90°****Gear Life : 12,000 hours (based on 12 hours per day usage)****Bevel Gears Steel MOD 1-6****DISCOUNTS**

	1 - 5	List Price
	6 - 19	- 5%
	20 - 39	- 10%
	40 - 59	- 15%
	60 - 99	- 20%
	100 - 200	- 30%

TORQUE CHECK	16 teeth x 1000 rpm									
	1.0 MOD	1.5 MOD	2.0 MOD	2.5 MOD	3.0 MOD	3.5 MOD	4.0 MOD	4.5 MOD	5.0 MOD	6.0 MOD
TORQUE Nm.	0.33	1.11	2.69	4.90	7.69	11.56	16.16	22.2	30.30	42
K.W.	0.035	0.12	0.28	0.51	0.81	1.21	1.74	2.33	3.17	4.41

PART NUMBER	No. of TEETH	MOD	d <sub>a</sub>	d	b	l <sub>n</sub>	d <sub>n</sub>	B	t <sub>B</sub>	h	t <sub>H</sub>	t <sub>E</sub>	Weight kg	PRICE EA. 1-5
151-710-015	15	1.0	16.94	15.0	9.0	7.7	12.5	5.0	38.0	16.9	16.5	8.24	0.012	£21.11
151-710-060	60		60.49	60.0	9.0	10.0	35.0	12.0	23.0	18.4	16.5	16.47	0.195	£84.63
151-715-015	15	1.5	25.41	22.5	12.0	11.5	19.0	8.0	57.0	23.9	23.0	12.36	0.042	£22.08
151-715-060	60		90.74	90.0	12.0	15.5	50.0	16.0	33.0	25.7	23.0	23.21	0.570	£141.51
151-720-015	15	2.0	33.88	30.0	16.0	14.5	25.0	12.0	75.0	30.8	30.0	15.48	0.092	£42.81
151-720-060	60		120.97	120.0	16.0	22.0	65.0	20.0	45.0	35.3	32.0	31.94	1.335	£171.95
151-725-015	15	2.5	42.35	37.5	20.0	17.0	31.0	14.0	93.0	37.8	36.0	18.60	0.180	£50.75
151-725-060	60		151.21	150.0	20.0	25.0	80.0	22.0	53.0	40.9	36.0	36.73	2.370	£203.37
151-730-015	15	3.0	50.82	45.0	24.0	20.0	38.0	16.0	111.0	44.8	43.0	21.73	0.325	£60.55
151-730-060	60		181.45	180.0	24.0	28.0	95.0	28.0	62.0	47.4	42.0	42.41	4.060	£242.80
151-735-015	15	3.5	59.29	52.5	28.0	23.0	44.0	18.0	129.0	51.7	50.0	24.85	0.515	£72.92
151-735-060	60		211.69	210.0	28.0	30.0	110.0	32.0	69.0	52.0	46.0	46.15	6.160	£294.12
151-740-015	15	4.0	67.76	60.0	32.0	23.5	48.0	20.0	145.0	56.8	55.0	25.97	0.860	£110.37
151-740-060	60		241.92	240.0	32.0	35.0	125.0	35.0	80.0	60.6	53.0	53.88	9.060	£441.22
151-745-015	15	4.5	76.23	67.5	36.0	25.5	55.0	22.0	162.0	62.9	60.0	28.09	1.240	£154.85
151-745-060	60		272.16	270.0	36.0	37.5	140.0	40.0	88.0	66.2	57.0	58.62	12.950	£621.53
151-750-015	15	5.0	84.70	75.0	40.0	28.1	60.0	25.0	180.0	69.7	67.0	31.21	1.760	£228.63
151-750-060	60		302.40	300.0	40.0	38.0	160.0	45.0	95.0	70.8	62.0	62.35	17.820	£904.47
151-760-015	15	6.0	101.64	90.0	45.0	28.1	75.0	25.0	210.0	74.7	71.0	31.45	2.420	£388.43
151-760-060	60		362.88	360.0	45.0	38.0	180.0	50.0	103.0	73.3	62.0	63.82	25.150	£1545.27

**232**Unit 14, Foxwood Industrial Park, Foxwood Road, Chesterfield, Derbyshire S41 9RN  
Telephone +44(0)1246 268080 Fax +44(0)1246 260003