

# Materials **Anti-backlash Wormwheels**

STD : Phosphor Bronze PB2

SPECIAL TEETH : between 60 - 300

## 64 DP

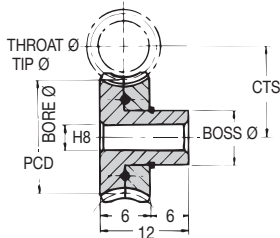

**20° Pressure Angle**

### DISCOUNTS

1 - 5	List Price
6 - 19	- 12%
20 - 39	- 25%
40 - 59	- 33%
60 - 99	- 37%
100 - 200	- 42%

<b>TORQUE CHECK</b>	50 TEETH x 1000 R.P.M. INPUT
variations at back	with std worm
<b>TORQUE Nm</b>	0.056
<b>K.W.</b>	0.0012

PART NUMBER	TEETH	PCD (ins)	CTS (ins)	THROAT Ø (ins)	TIP Ø (ins)	BOSS Ø (ins)	BORE Ø (ins)	PRICE EACH 1-5
ABM64-60	60	0.938	0.656	0.969	0.984	0.500	0.187	£35.86
ABM64-62	62	0.969	0.672	1.000	1.016	0.500	0.187	£36.32
ABM64-64	64	1.000	0.688	1.031	1.047	0.500	0.187	£36.73
ABM64-68	68	1.063	0.719	1.094	1.109	0.500	0.187	£37.20
ABM64-70	70	1.094	0.734	1.125	1.141	0.500	0.187	£37.61
ABM64-72	72	1.125	0.750	1.156	1.172	0.500	0.187	£38.06
ABM64-75	75	1.172	0.773	1.203	1.219	0.500	0.187	£38.54
ABM64-76	76	1.188	0.781	1.219	1.234	0.500	0.187	£38.94
ABM64-80	80	1.250	0.813	1.281	1.297	0.500	0.187	£39.51
ABM64-84	84	1.313	0.844	1.344	1.359	0.500	0.187	£39.77
ABM64-85	85	1.328	0.852	1.359	1.375	0.500	0.187	£40.68
ABM64-86	86	1.344	0.859	1.375	1.391	0.500	0.187	£41.49
ABM64-90	90	1.406	0.891	1.438	1.453	0.500	0.187	£42.54
ABM64-92	92	1.438	0.906	1.469	1.484	0.500	0.187	£43.44
ABM64-94	94	1.469	0.922	1.500	1.516	0.500	0.187	£44.33
ABM64-96	96	1.500	0.938	1.531	1.547	0.500	0.187	£45.26
ABM64-100	100	1.563	0.969	1.594	1.609	0.500	0.187	£46.14
ABM64-110	110	1.719	1.047	1.750	1.766	0.500	0.187	£47.02
ABM64-120	120	1.875	1.125	1.906	1.922	0.500	0.187	£57.13
ABM64-130	130	2.031	1.203	2.063	2.078	0.500	0.187	£66.36
ABM64-140	140	2.188	1.281	2.219	2.234	0.500	0.187	£72.68
ABM64-150	150	2.344	1.359	2.375	2.391	0.500	0.187	£77.89
ABM64-200	200	3.125	1.750	3.156	3.172	0.750	0.250	£104.04
ABM64-300	300	4.688	2.531	4.719	4.734	0.750	0.250	£121.36

**Anti-backlash Wormwheels** DP 64

Unit 14, Foxwood Industrial Park, Foxwood Road, Chesterfield, Derbyshire S41 9RN

Telephone +44(0)1246 268080

Fax +44(0)1246 260003



**327**