

Anti-backlash Wormwheels *Materials*

2 MOD

STD : Phosphor Bronze PB2
SPECIAL TEETH : between 40 - 80

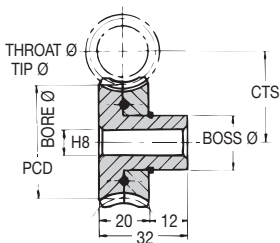

20° Pressure Angle

| | |
|---------------------|------------------------------|
| TORQUE CHECK | 50 TEETH x 1000 R.P.M. INPUT |
| variations at back | with std worm |
| TORQUE Nm | 4.50 |
| K.W. | 0.0094 |

DISCOUNTS

| Quantity | List Price |
|-----------|------------|
| 1 - 5 | - |
| 6 - 19 | - 12% |
| 20 - 39 | - 25% |
| 40 - 59 | - 33% |
| 60 - 99 | - 37% |
| 100 - 200 | - 42% |

Anti-backlash Wormwheels MOD 2

| PART NUMBER | TEETH | PCD (mm) | CTS (mm) | THROAT Ø (mm) | TIP Ø (mm) | BOSS Ø (mm) | BORE Ø (mm) | PRICE EACH 1-5 |
|-------------|-------|----------|----------|---------------|------------|-------------|-------------|----------------|
| ABM2-40 | 40 | 80 | 52.50 | 84 | 86 | 50 | 20 | £136.20 |
| ABM2-42 | 42 | 84 | 54.50 | 88 | 90 | 50 | 20 | £155.03 |
| ABM2-44 | 44 | 88 | 56.50 | 92 | 94 | 50 | 20 | £173.93 |
| ABM2-45 | 45 | 90 | 57.50 | 94 | 96 | 50 | 20 | £192.81 |
| ABM2-46 | 46 | 92 | 58.50 | 96 | 98 | 50 | 20 | £211.71 |
| ABM2-48 | 48 | 96 | 60.50 | 100 | 102 | 50 | 20 | £230.59 |
| ABM2-50 | 50 | 100 | 62.50 | 104 | 106 | 50 | 20 | £241.23 |
| ABM2-52 | 52 | 104 | 64.50 | 108 | 110 | 50 | 20 | £251.81 |
| ABM2-54 | 54 | 108 | 66.50 | 112 | 114 | 50 | 20 | £262.46 |
| ABM2-55 | 55 | 110 | 67.50 | 114 | 116 | 50 | 20 | £273.06 |
| ABM2-56 | 56 | 112 | 68.50 | 116 | 118 | 50 | 20 | £283.69 |
| ABM2-58 | 58 | 116 | 70.50 | 120 | 122 | 50 | 20 | £295.50 |
| ABM2-60 | 60 | 120 | 72.50 | 124 | 126 | 50 | 20 | £307.35 |
| ABM2-62 | 62 | 124 | 74.50 | 128 | 130 | 50 | 20 | £319.15 |
| ABM2-64 | 64 | 128 | 76.50 | 132 | 134 | 50 | 20 | £331.00 |
| ABM2-65 | 65 | 130 | 77.50 | 134 | 136 | 50 | 20 | £342.84 |
| ABM2-66 | 66 | 132 | 78.50 | 136 | 138 | 50 | 20 | £354.64 |
| ABM2-68 | 68 | 136 | 80.50 | 140 | 142 | 50 | 20 | £366.47 |
| ABM2-70 | 70 | 140 | 82.50 | 144 | 146 | 50 | 20 | £384.60 |
| ABM2-72 | 72 | 144 | 84.50 | 148 | 150 | 50 | 20 | £402.77 |
| ABM2-74 | 74 | 148 | 86.50 | 152 | 154 | 50 | 20 | £420.90 |
| ABM2-75 | 75 | 150 | 87.50 | 154 | 156 | 50 | 20 | £439.08 |
| ABM2-76 | 76 | 152 | 88.50 | 156 | 158 | 50 | 20 | £457.19 |
| ABM2-78 | 78 | 156 | 90.50 | 160 | 162 | 50 | 20 | £475.35 |
| ABM2-80 | 80 | 160 | 92.50 | 164 | 166 | 50 | 20 | £493.46 |

326



Unit 14, Foxwood Industrial Park, Foxwood Road, Chesterfield, Derbyshire S41 9RN
Telephone +44(0)1246 268080 Fax +44(0)1246 260003