

Materials

Anti-backlash Gears

STD : Stainless Steel 303S21/304S31 (En58)
and Steel 214M15/045M10

48, 32, 24 DP

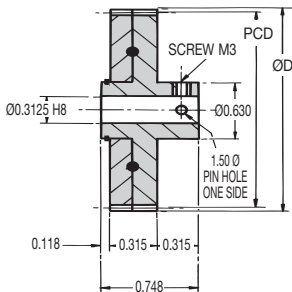

20° Pressure Angle

Other numbers of teeth available

DISCOUNTS

1 - 5	List Price
6 - 19	- 12%
20 - 39	- 25%
40 - 59	- 33%
60 - 99	- 37%
100 - 200	- 42%

TORQUE CHECK variations at back	50 TEETH x 1000 R.P.M.		
	48 DP	32 DP	24 DP
TORQUE Nm.	0.0658	0.148	0.063
K.w.	0.006	0.0156	0.027

PART NUMBER		PITCH	TEETH	PCD (ins)	ØD (ins)	PRICE EACH 1-5	
STEEL AB	STAINLESS ABS					AB	ABS
AB48-55	ABS48-55	48	55	1.146	1.187	£32.45	£42.63
AB48-60	ABS48-60	48	60	1.250	1.292	£32.71	£45.70
AB48-72	ABS48-72	48	72	1.500	1.542	£33.05	£48.51
AB48-84	ABS48-84	48	84	1.750	1.792	£33.36	£48.80
AB48-96	ABS48-96	48	96	2.000	2.042	£33.59	£51.57
AB48-108	ABS48-108	48	108	2.250	2.292	£34.06	£54.36
AB48-120	ABS48-120	48	120	2.500	2.542	£34.72	£57.13
AB48-132	ABS48-132	48	132	2.750	2.792	£35.63	£59.90
AB48-144	ABS48-144	48	144	3.000	3.042	£35.86	£62.76
AB32-48	ABS32-48	32	48	1.500	1.562	£33.18	£47.79
AB32-56	ABS32-56	32	56	1.750	1.812	£33.85	£48.80
AB32-64	ABS32-64	32	64	2.000	2.062	£35.01	£51.25
AB32-72	ABS32-72	32	72	2.250	2.312	£35.03	£54.42
AB32-80	ABS32-80	32	80	2.500	2.562	£35.12	£56.57
AB32-88	ABS32-88	32	88	2.750	2.812	£35.67	£58.63
AB32-96	ABS32-96	32	96	3.000	3.062	£36.03	£59.72
AB32-100	ABS32-100	32	100	3.125	3.187	£36.47	£61.89
AB24-48	ABS24-48	24	48	2.000	2.083	£34.89	£60.48
AB24-60	ABS24-60	24	60	2.500	2.583	£37.60	£62.85
AB24-72	ABS24-72	24	72	3.000	3.083	£38.98	£64.05
AB24-80	ABS24-80	24	80	3.333	3.417	£40.74	£65.60
AB24-84	ABS24-84	24	84	3.500	3.583	£41.94	£69.25
AB24-96	ABS24-96	24	96	4.000	4.083	£46.38	£70.97

Anti-backlash Gears

Steel & Stainless DP 48, 32, 24

Unit 14, Foxwood Industrial Park, Foxwood Road, Chesterfield, Derbyshire S41 9RN
Telephone +44(0)1246 268080 Fax +44(0)1246 260003



375